

Polk County Assessor

111 Court Avenue #195
Des Moines, IA 50309-0904

(515) 286-3014 Fax (515) 286-3386
polkweb@assess.co.polk.ia.us

Location					
Address	125 NW AURORA AVE				
City	DES MOINES	Zip	50313	Jurisdiction	Saylor Township
District/Parcel	270/02060-001-000	Geoparcels	7924-23-154-036	Status	Active
School	Saydel	Nbhd/Pocket	SA01/B	Tax Authority Group	SAY-T-SAY-77104
Submarket	Northeast Des Moines	Appraiser	Braxton Peats 515-286-3839		

Map and Current Photos - 2 Records

Click on parcel to get a new listing

[Bigger Map](#) [Polk County GIS](#)
[Google Map](#) [Pictometry](#)



[Historical Photos](#)

Ownership - 1 Record

Ownership	Num	Name	Recorded	Book/Page
-----------	-----	------	----------	-----------

Ownership	Num	Name	Recorded	Book/Page	
Title Holder	1	ANTIOCH INVESTMENTS LC	2010-12-28	13717/233	
Legal Description and Mailing Address					
E 14.75F W 173.5F N 75F & E 22.25F W 173.5F S 75F N 150F & E 129F LOT 9 ORP NORTH HIGHLAND PARK			ANITIOCH INVESTMENTS LC 310 NW WATERCREST DR ANKENY, IA 50023-6807		
Current Values					
Type	Class	Kind	Land	Bldg	Total
2022 Value	Residential 3+	Full	\$95,900	\$303,100	\$399,000
Unadjusted Cost Report					
Zoning - 1 Record					
Zoning	Description	SF	Assessor Zoning		
MDR	Medium Density Residential		Residential		
<i>Polk County Department of Planning & Development 515 286 3705 (2007-10-01)</i>					
Land					
Square Feet	41,475	Acres	0.952	Topography	Blank
Shape	Irregular	Vacancy	Blank	Unbuildable	Blank
Residences - 1 Record					
Residence #1					
Occupancy	Single Family	Residence Type	1 Story	Year Built	1959
Number Families	1	Grade	4-05	Condition	Below Normal
Total Square Foot Living Area	1064	Main Living Area	1064	Attached Garage Square Foot	392
Basement Area	1064	Garage Brick%	100	Enclosed Porch Area	48
Foundation	Concrete Block	Exterior Wall Type	Brick	Brick%	100
Roof Type	Gable	Roof Material	Asphalt Shingle	Heating	Gas Forced Air
Air Conditioning	100	Number Bathrooms	1	Bedrooms	3
Rooms	5				

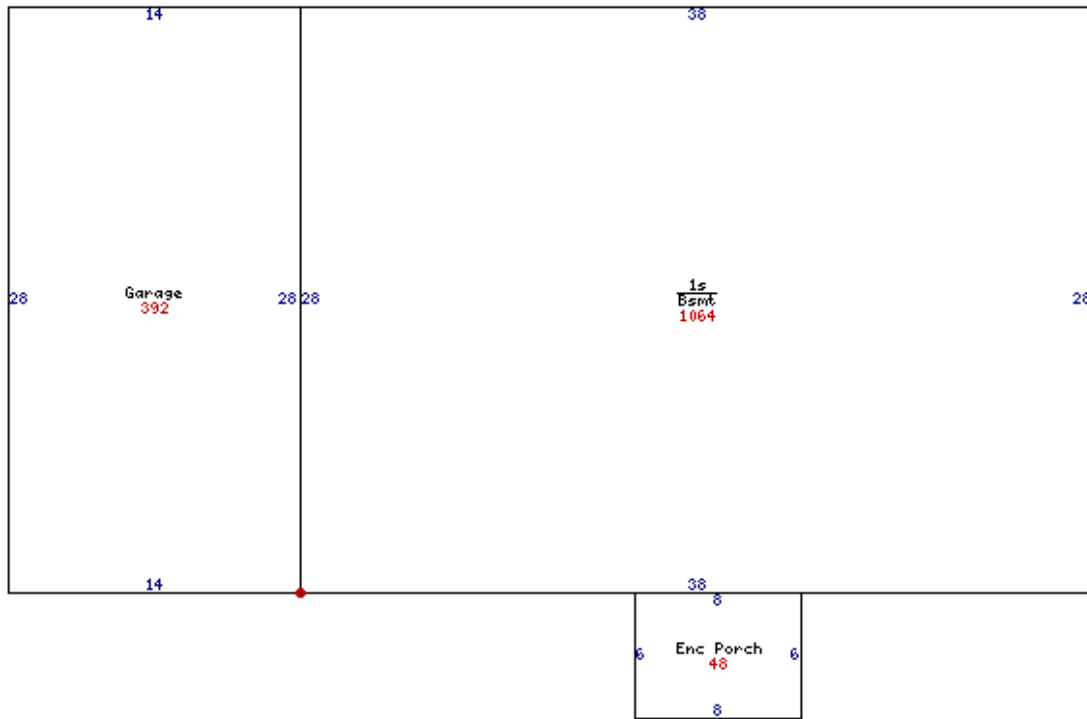

Commercial Summary

Occupancy	Apartment	Age, Weighted	1951	Total Story Height	1
Land Area	41,475	Gross Area	7,168	Finished Area	6,776
Unfinished Bsmt Area	1,064	Finished Bsmt Area	0	Number of Units	11
Primary Group	Apartment	Percent Primary Group	69.39	Secondary Group	Residence Single Family
Percent Secondary Group	30.61	Grade, Weighted	5/Grade 5	Bldg Class, Weighted	5/Metal
Condition, Weighted	NM/Normal	Ground Floor Area	6,776	Perimeter	706
Unfinished Area	392				

Commercial Sections - 1 Record

Commercial Section #101

Section Multiplier	1	Occupancy	Apartment	Foundation	Concrete
Exterior Wall	Brick Veneer	Insulation	Yes	Roof	Gable
Roof Material	Shingle	Wiring	Adequate	Plumbing	Adequate
Total Story Height	1	Frame Type	Frame	Bldg Class	Brick Veneer
Total Section Area	5,712	Ground Floor Area	5,712	Perimeter	706
Total Number Units	10	Grade	5-10	Year Built	1948
Condition	Poor				

Commercial Groups - 1 Record					
Commercial Group #101 1					
Use Code	Apartment	Base Story	1	Number Stories	1
Total Group Area	5,712	Base Floor Area	5,712	Number Units	10
Heating	Central	Air Conditioning	None	Exhaust System	No
Condition	Normal				

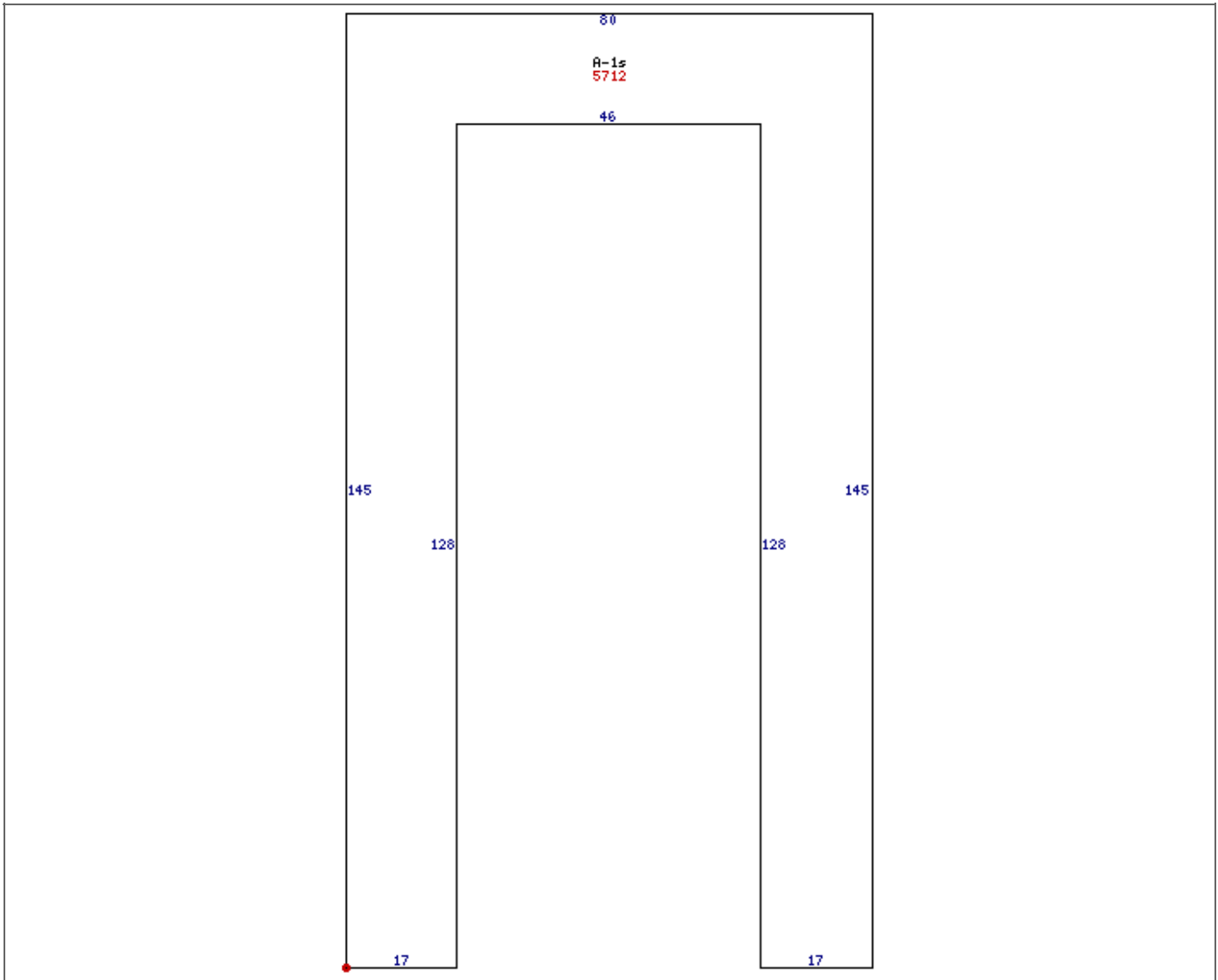

Detached Structures - 1 Record

Detached Structure #101

Occupancy	Asphalt Paving	Measurement Code	Square Feet	Measure 1	10,000
Grade	5	Year Built	1970	Condition	Below Normal

Sales - 1 Record

Seller	Buyer	Sale Date	Sale Price	Instrument	Book/Page
GREAT SOUTHERN BANK	ANTIOCH INVESTMENTS, LC	2010-12-20	\$150,000	Deed	13717/233

Historical Values

Yr	Type	Class	Kind	Land	Bldg	Total
2021	Assessment Roll	Multi-Residential	Full	\$95,900	\$303,100	\$399,000
2019	Assessment Roll	Multi-Residential	Full	\$87,200	\$239,800	\$327,000
2017	Assessment Roll	Multi-Residential	Full	\$87,200	\$184,800	\$272,000
2015	Assessment Roll	Multi-Residential	Full	\$71,900	\$174,100	\$246,000

Yr	Type	Class	Kind	Land	Bldg	Total
2013	Assessment Roll	Multi-Residential	Full	\$71,900	\$147,000	\$218,900
2011	Assessment Roll	Multi-Residential	Full	\$71,900	\$147,000	\$218,900
2010	Assessment Roll	Multi-Residential	Full	\$71,900	\$147,000	\$218,900

This template was last modified on Thu Jun 3 19:39:49 2021 .